

# G1 Wi-Fi Module Set Up Instructions

## Getting Started : Creating an Account

- Search for " eWeLink " on your device: AppStore/Google Play  
Download the app to your device.



- You must create an account using a valid email account. Tap on register to begin.
- Enter an email address that will be associated with this account and tap next.
- Tap on " Send Code" You will receive an e-mail with a Verification code, enter the code and create a password. Log in when once you create an account.

Three screenshots of the eWeLink app registration process. The first screenshot shows the login screen with fields for phone number/email and password, and a 'Login' button. The second screenshot shows the 'Email Address' field with a 'Next' button. The third screenshot shows the 'Verification code' field with a 'Send code' button. Red arrows indicate the flow from the first to the second, and from the second to the third. The 'Register' button is also visible in the first and third screenshots.

USA(+1) > Phone number,email Password Login Reset Password Login Register Feedback

Email Address Next Have an account, log in now

Verification code 0/10 Send code Password Confirm password For your safety, password must contain at least 8 characters Register Have an account, log in now

- Next you must pair the device : **Press and hold** the "Config" button located on the G1 Module for 5 seconds , Then release it . **Press and hold** the "Config" again until the red LED light begins to flash rapidly.



# G1 Wi-Fi Module Set Up Instructions

- In the App, tap on the "+" located at the bottom of the screen to add the device.
- Select Compatible Pairing mode (AP) and tap on next.

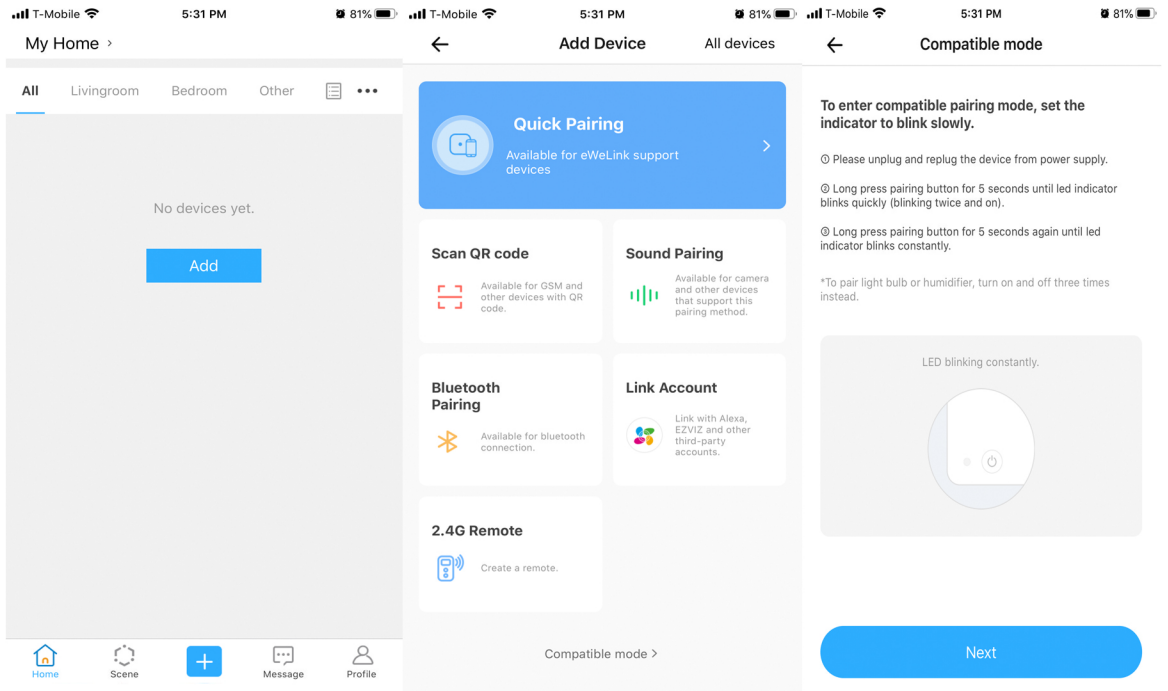

- Go onto your Smart Phones Wi-Fi settings and search for "ITEAD\*\*\*\*\*", Go back to APP click Next the default password is "12345678"

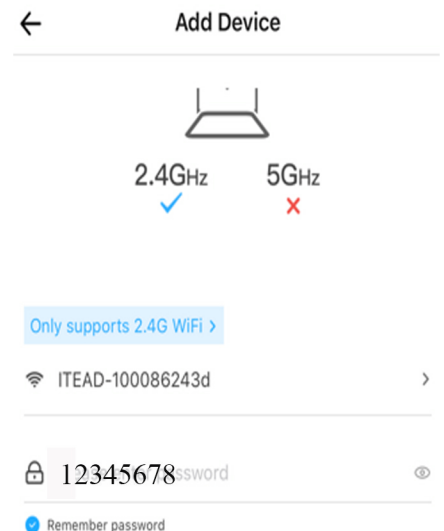
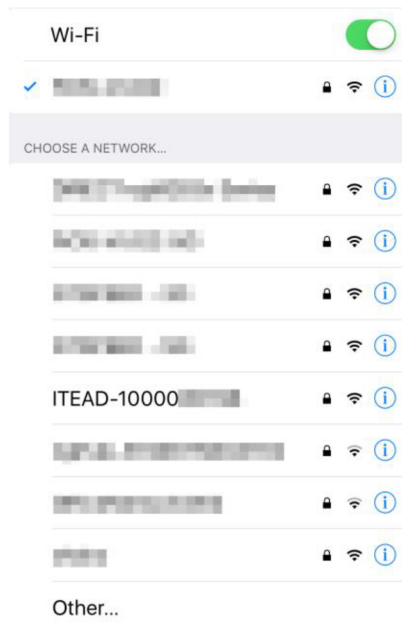
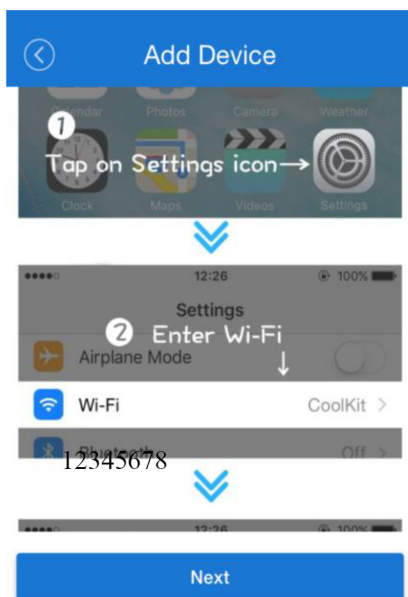

# G1 Wi-Fi Module Set Up Instructions

- Return to the eWeLink app and tap next, you will be prompted to enter your Local Wi-Fi Password. Tap next and the device will begin to connect.

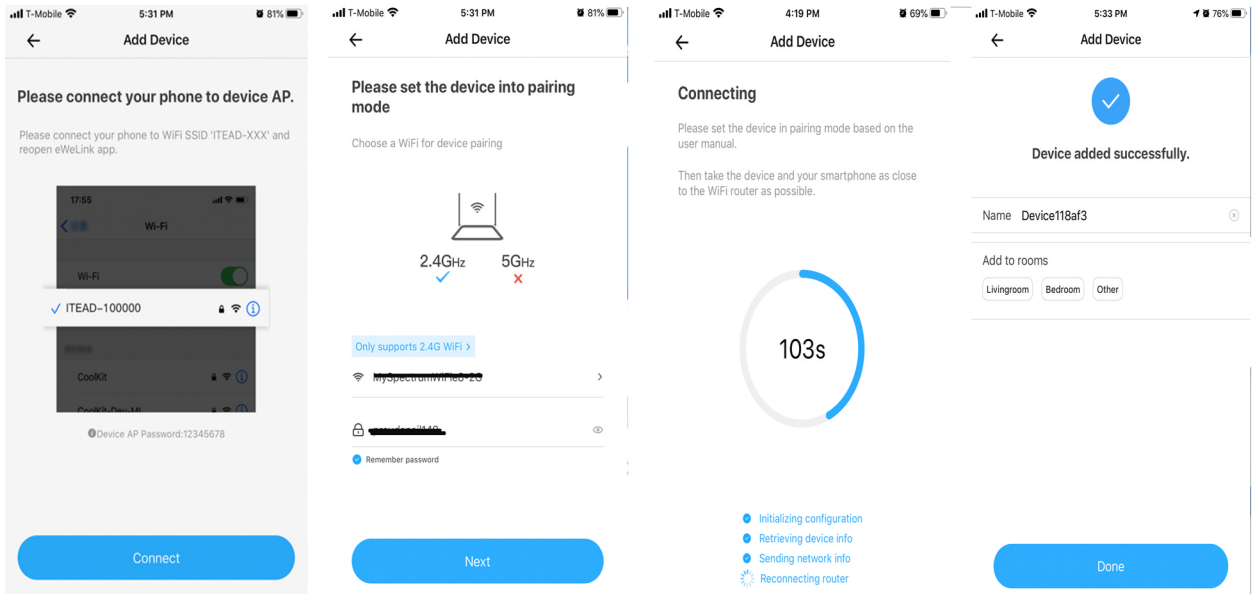

- Once added you should now be able to see the device on the main screen. Tap it to unlock the door.
- To add an additional device, follow the same steps using your existing account.

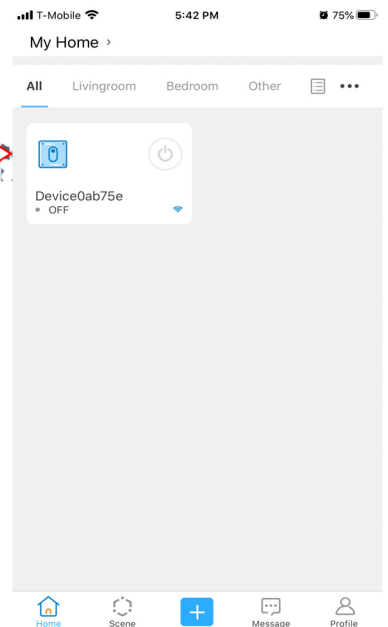
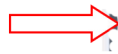

# G1 Wi-Fi Module Set Up Instructions

## Sharing the device with another user.

- To share the device, TAP on the **device name**. This will bring you to another display. Next tap on the Top Left ... to select share

*The user you will share the device with must create an account to receive a share invite.*

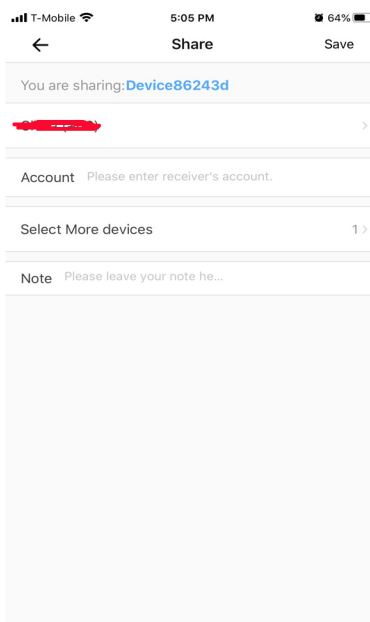
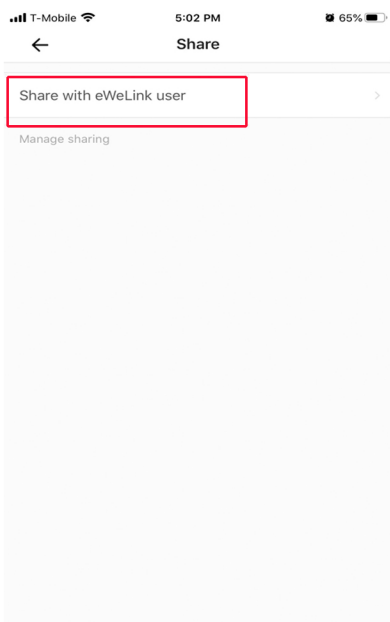
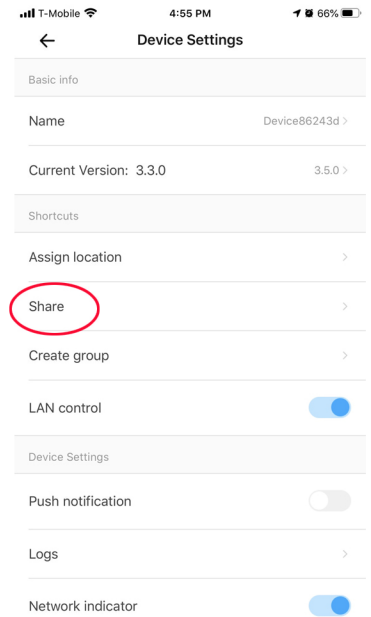
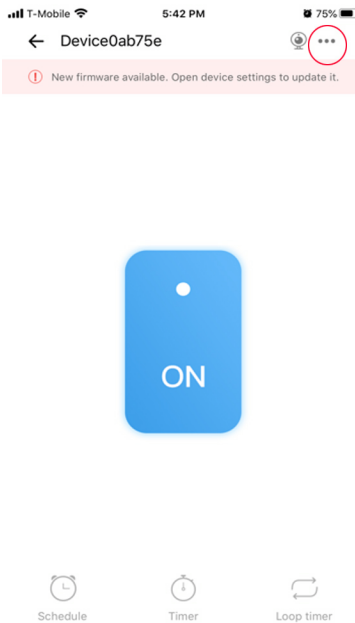
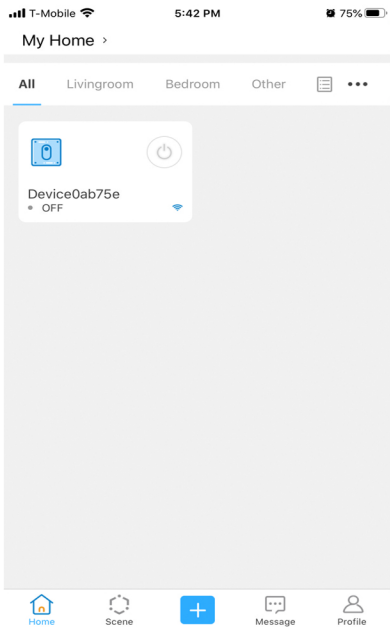



# G1 Wi-Fi Module Set Up Instructions

- Type in the users active account and click ok, you will get a message stating the invite was sent successfully.
- The user will receive a message, if they agree they will be able to see the device on their Smart Phone app.
- If the permission is given, they can open the door and use some of the functions of the device such as setting up a timer to unlock/lock.
- Using the Admin account you can set user permissions for users that are added to the shared devices.

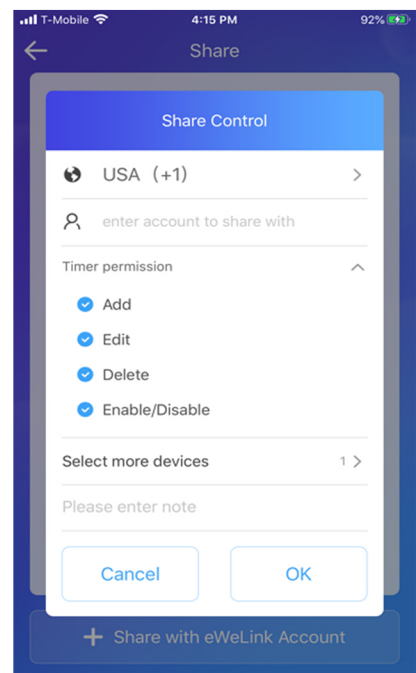
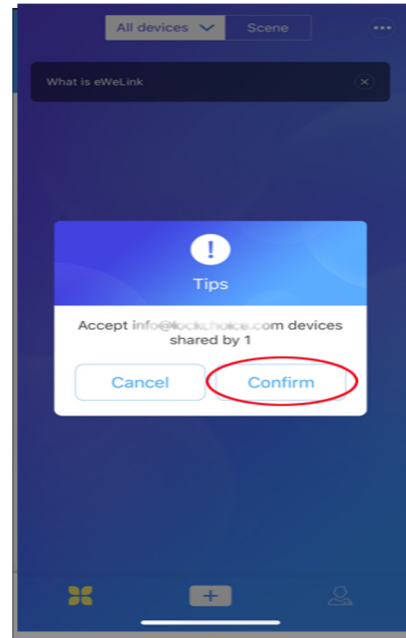

# G1 Wi-Fi Module Set Up Instructions

## Setting an Unlock/Lock Schedule or timer

- To set up a timer or daily scheduled timer event tap on the device name.  
The tap on the timer Icon .



- . In the Schedule , Timer and Loop Timer , You can set a one time unlock or weekly Scheduled Lock/Unlock .
- When setting up an extended period for the lock to be open, you must switch the operation modes on the G-1 Wi-Fi Module by pushing the Mode button. This will unlock the lock until the next scheduled lock time. If you do not switch the mode, the lock will only be open for the preset times : 3s, 6s, or 9s.

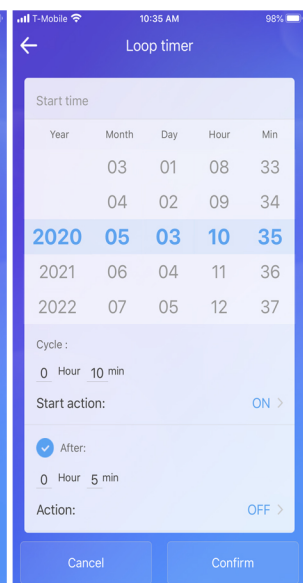
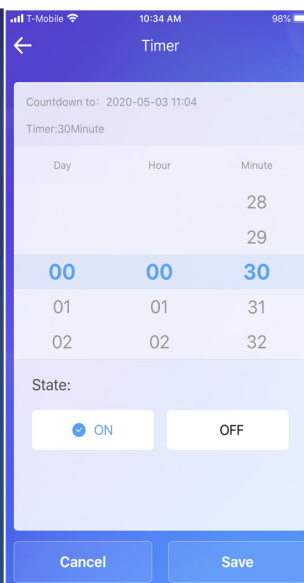
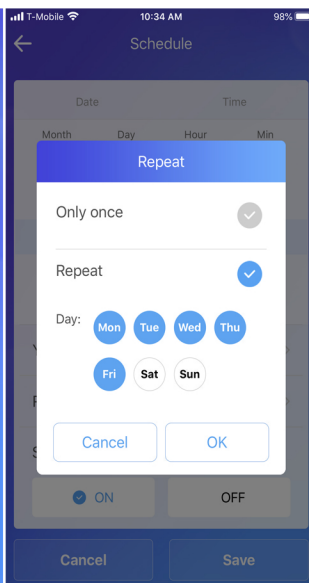
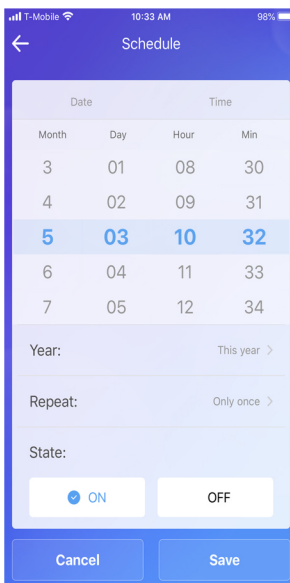

# G1 Wi-Fi Module Set Up Instructions

## Changing the open time delay

- To change the delay time duration for unlocking you must simultaneously press the "CONFIG" and "Model Switch" buttons . The default delay time is set to 3 Seconds. Pressing it once will change it to 6 seconds and again for 9 seconds. There are indicator LED lights showing the delay time.

