

HOTEL LOCK INSTALLATION INSTRUCTION

ANSI Lockcase (deadbolt above)

Electronic Hotel Door Lock

- Thank you for purchasing our product.
- Please read this manual carefully before use.
- Please keep this manual safe for future reference.

Required Tools for Installation

Rj Intru Screwdriver	Drill	Angle Ruler	Lead Pencil	Wrench
Chisel	Hammer	Stiletto	Stiletto	Stiletto
		Ø38mm	Ø15mm	Ø12mm

1 HOLE DRILLING

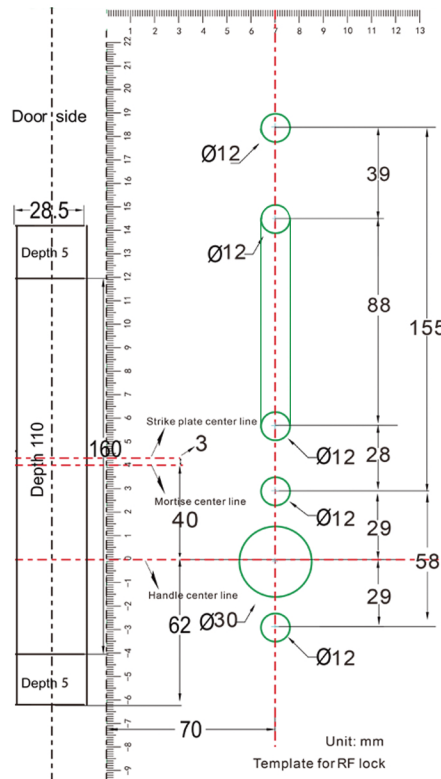

1.1 Mark horizontal line as the center line of handle, vertical line as the center line of door thickness.

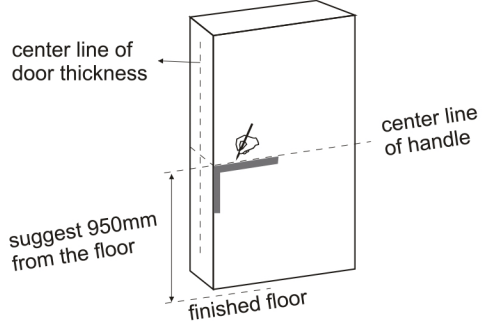

From finished door, measure desired height(950mm as recommended) on door. Stretch it to a horizontal line cross 3 sides of the door. Draw a vertical line on the center of the door edge.

1.2 Mark the positions of all holes according to the template

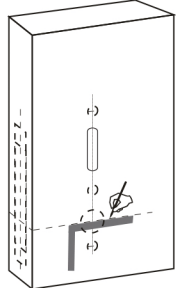

Tips: Mark the hole positions on the back of door in same way. The hole on the door edge is on the center of door edge.

1.3 Drill holes on the door face

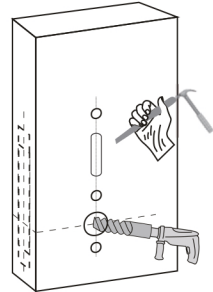

Tips: Choose proper stiletto according to the hole sizes. It is suggested to drill halfway from each side of the door to avoid damage to the door.

1.4 Locate the hole on the door edge

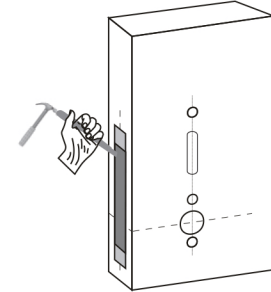

Note: The part with color  should be opened only to a depth of 5mm.

2 LOCK INSTALLATION

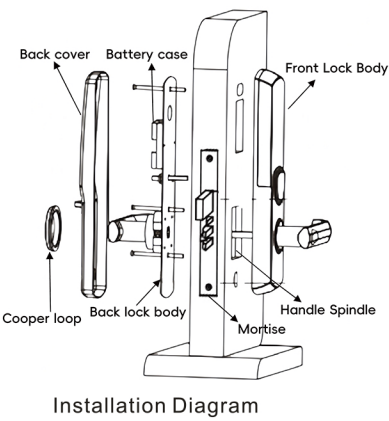

2.2 Install the front lock body

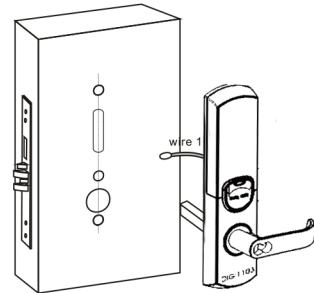

2.3 Install the back lock body

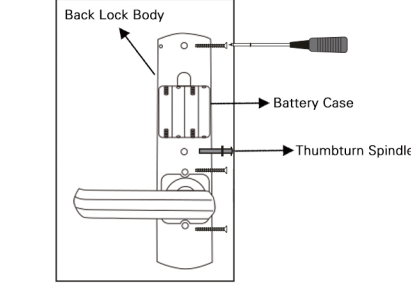

Tighten the three long screws on the back lock body, and insert the thumbturn spindle into the relative hole.

2.1 Install the mortise and mortise plate

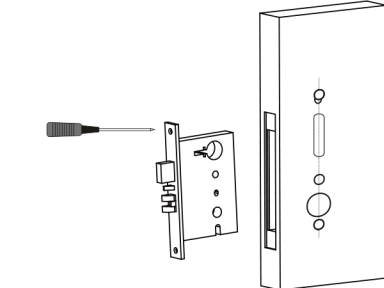

Tips: Keep the deadbolt unlocked. Get the wire 1 on the mortise to go through the relative hole.

Connect wire 1, Get the handle spindle to go through the relative hole on the mortise and get the front lock body to be close to the door face.

2.4 Install batteries(4 x 1.5V AA Alkaline)

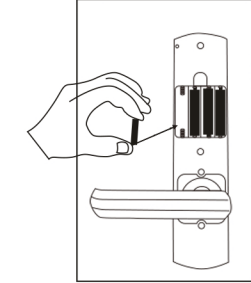

Tighten the four screws on the back lock body. **Tips:** Remember to connect the power wire with the battery case.

2.5 Fix the back cover

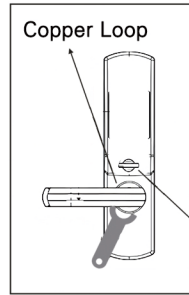

Insert the handle spindle into the back handle. Turn and adjust the thumbturn till it can operate the deadbolt. Fix the back cover on the back lock body and tighten the copper loop with the wrench.

2.6 Test the installed lock

Step1

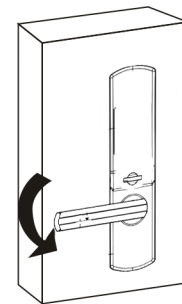

Tips: Test the latches by turning the back handle and thumbturn before fixing the copper loop. If the latches are too tight, loosen the three long screws on the back lock body a little.

Step2

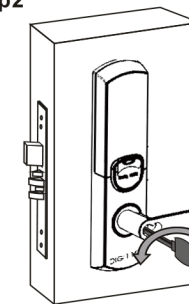

Use any tiny spike to remove the cylinder cover. Rotate the key 90 degrees counter-clockwise, then turn the handle to see whether it can open the lock.

Step3

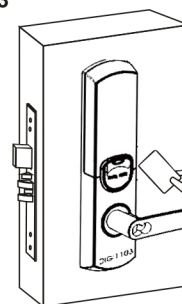

Swipe the reset card on the lock to see whether the green indicator light is on.

Note: After lock testing, keep the deadbolt unlocked again to avoid possible damage to the door frame.

3 STRIKE PLATE INSTALLATION

3.1 Locate the strike plate

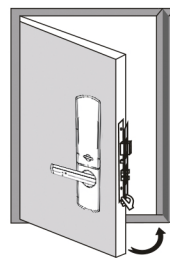

Match the strike plate on the latches properly by your hand, and get the latches to be on the hole centers of the strike plate. Try closing the door and mark the position of the strike plate on the door frame.

3.2 Open the hole on the door frame with a chisel

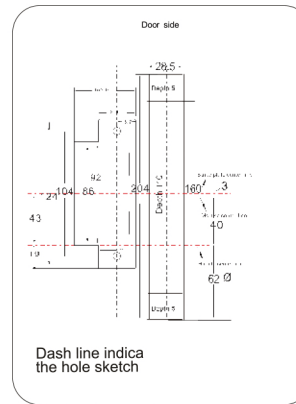
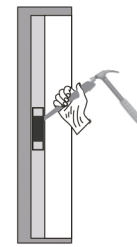

3.3 Install the strike plate

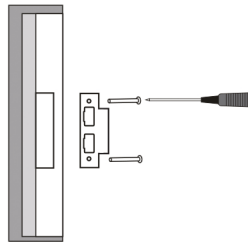

3.4 Test the strike plate

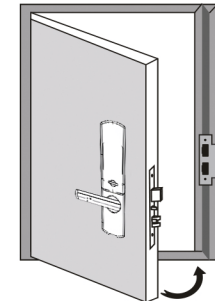

Close the door to see whether the latches are matching the strike plate.

Tips: You are suggested to close the door and test unlocking by override key again.